

AHC40 Actuator with weather compensated controller

Main features

Application	control of heating system and mixing valves
Description	Actuator with AHC weather compensated controller combines control of a mixing valve with a heating system control following an OTC curve; the side LEDs indicate momentary movement direction, the middle LED indicates the state of the valve (OK=green, FAULT=red); the position of the valve member can be read from the sight glass (blue vs. red)
Connection to valve	included is a set of adapters for connection of valves of various manufacturers: 1ASCAVMSA for Esbe, Seltron, Somatherm, Acaso, IVAR, WIP, PAW, BRV, IMIT, Hora, Barberi, Olymp, Hoval; 1ASCAVMSG for Esbe VRG
Code	16 253

Technical data

Control	weather compensated control
Mixing valve control	to a temperature following an OTC curve
Torque	6 Nm
Angle of rotation	90°
Shift time	120 s
Power supply	230 V AC, 50 Hz
Max. power input	< 3.5 VA
Relay – output to circulation pump	5 (1) A, 250 V AC
Power consumption in standby mode	max. 0.25 VA
IP rating	IP42 by EN 60529
Protection class	I by EN 60730-1
Ambient temperature	5 to 40 °C
Teplota skladování	-20 to 65 °C

Dimensions, weight, material

Dimensions	101 x 84 x 88 mm
Weight	0.80 kg
Case material	PC

Power cable

Cross section area	3 x 0.75 mm ²
Electrical plug	yes, type E/F
Length	≈ 2 m

Temperature sensor

Type	Pt1000
Quantity	3 sensors are included in supply (max. 4 can be connected)
Marking	terminals distinguished by colours – red, black, blue (outdoor)
Cable length	1 m (red), 3 m (black), 15 m (blue)

Communication

Connection to other AHC40 controllers	BUS
---------------------------------------	-----

AHC40 Actuator with weather compensated controller

Pt1000 - graph of reaction time in water and temperature vs. resistance table

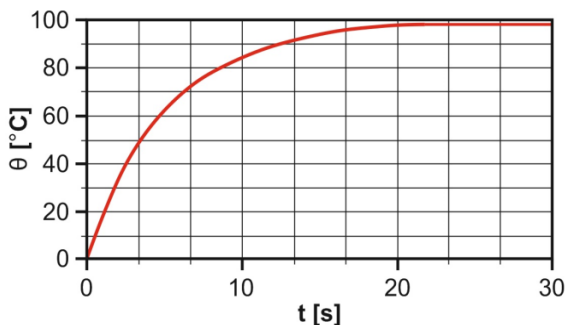

Temperature [°C]	Resistance [Ω]
0	1000
20	1078
40	1155
60	1232
80	1309
85	1328
90	1347
95	1366
100	1385

Heating curves graph

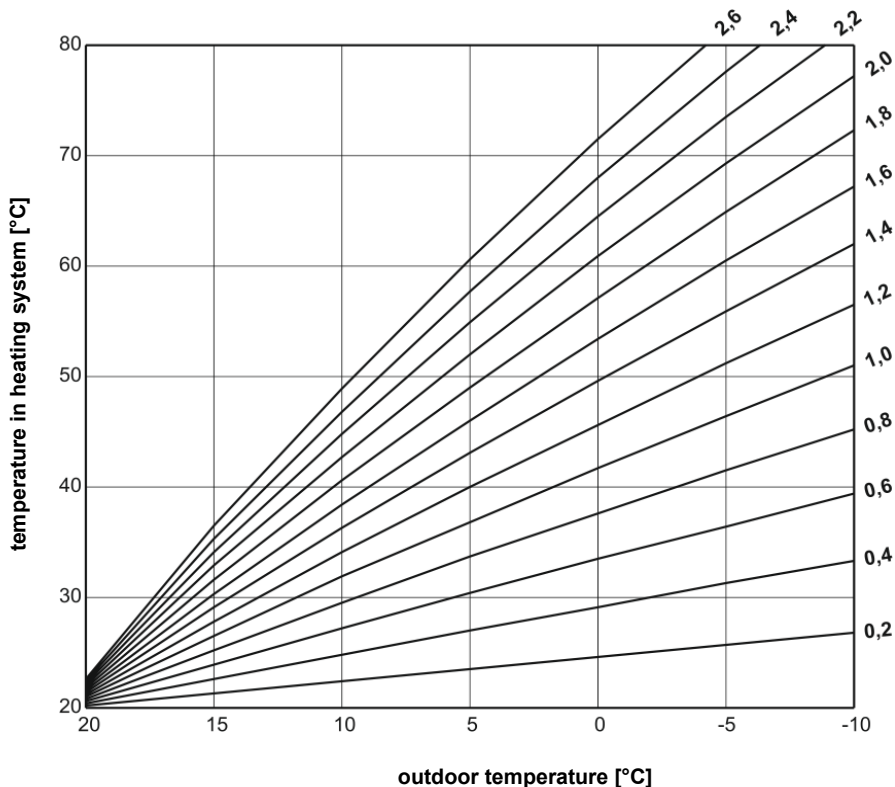

Cooling curves graph

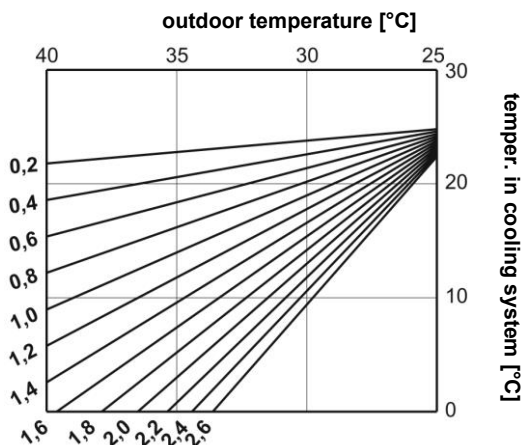

AHC40 Actuator with weather compensated controller

Wiring diagram

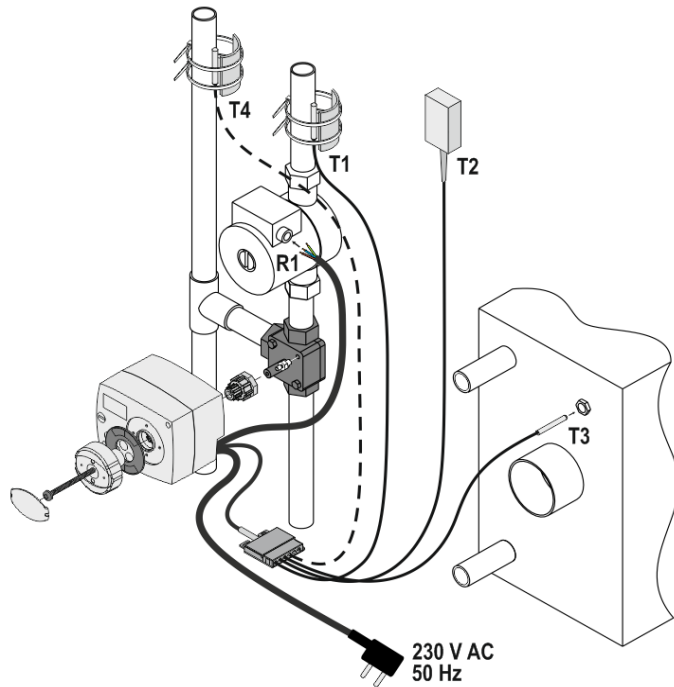

T1 - T4 ... temperature sensors
R1 ... pump switching