

TP39 - LCD Room Thermostat

Warranty Conditions

1. The warranty period is 24 months from the date of purchase.
2. When claiming warranty, this Warranty Card must be submitted together with the original purchase receipt.
3. Failure to respect technical conditions of the manufacturer will render the warranty null and void.
4. The warranty is null and void if the claimed defect is caused by tampering, improper handling, using the product for other purposes than described, using the product under improper conditions or by a natural disaster.
5. Claims shall be resolved by your reseller at the address shown below.

Warranty Card

Date of purchase:.....

Seller's rubber stamp print and signature:

Authorized importer:

Regulus spol. s r.o. Tel.: +420 241 762 726
 Do Koutů 1897/3 +420 241 764 506
 143 00 Praha 4 Fax: +420 241 763 976
 www.regulus.cz , e-mail: sales@regulus.cz

Description:

Electronic thermostat with digital thermometer. Temperature setting follows through rotating the knob (5) against informative scale. During temperature setting the set value (2) appears on the display and a hand symbol (1) on the left. 10 sec. after the temperature is set, the real room temperature appears on the display and the hand symbol disappears. The thermostat is of electronic type and temperature measuring is done every 2 minutes, so after any change in settings (demand for heat on or off) is done, switching occurs within 2 minutes. The state of thermostat is indicated by thermometer symbol (3). When the thermostat is „closed” (i.e. the boiler heats), the thermometer symbol flashes.



Recommended installation place:

The thermostat is designed for indoor use only. It should be placed on an inner wall about 150 cm above the floor, into a suitable space where changes in the room temperature can be registered thanks to freely circulating air. Do not mount above heat sources (TV set, heater, fridge etc.), to places exposed to direct sunshine, draught, radiation from instruments, nor to a laundry.

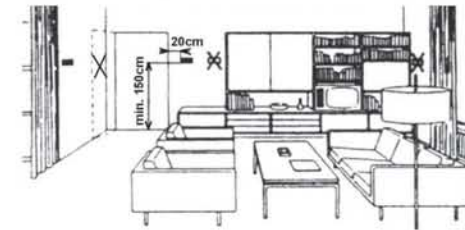

Technical data

| | |
|------------------------|--------------------------|
| Temperature range | 5-35°C, adjustable |
| Switching difference | about 1°C |
| Operation voltage | 230 V /50 Hz |
| IP | IP20 |
| Nominal contact load | 230 VAC, 16(3) A |
| Sensor | NTC thermistor |
| Frequency of measuring | about 2 min. |
| Operation temperature | 0-40°C |
| Storage temperature | 0-50°C |
| Operation humidity | 5-90% RH, non condensing |

1. Mounting instructions:

1. Removing the cover

- Loosen the screws (1) and (2) on the device bottom with a screwdriver.
- Lift off the cover from the bottom (3) and shift upwards (4) to release the top latch.

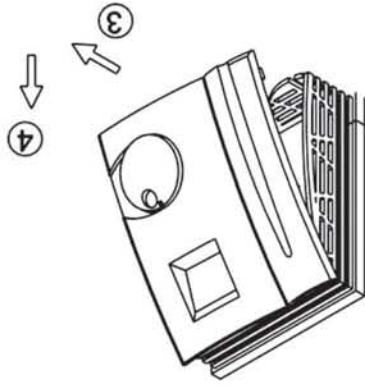
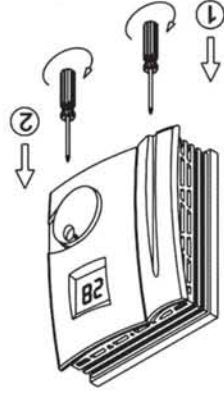

2. Mounting without a fixing board

- Make sure that the thermostat is placed horizontally.
- Place the thermostat so that the wires run through the opening not far from an electric box in the wall.
- Drill two holes into the wall, matching the two openings in the rear of the thermostat.
- Fix the thermostat onto the wall using two long screws and two sockets.

3. Mounting with a fixing board

- Put the fixing board onto the wall or electric box so that its position is horizontal and it fully covers the box.
- Thread the wires through its middle opening.
- Use 2 sockets for fixing.
- Attach the board with 2 long screws.
- Run the wires close to a terminal block.
- Attach the thermostat to the fixing board with 2 short screws.

4. Wiring

- Connect the appropriate wires to the terminal block.
- Finally, push all the wires back into the box.

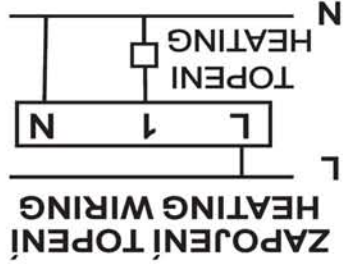

5. Repositioning the cover

- Turn the shaft into pos. (5a) – the slanted side horizontally.
- Turn the knob so that the mark pinpoints upwards (5b).
- Return the cover to place, mind it fits into the mechanism of the top latch.
- Press the cover back (7) and tighten the screws (8 and 9).
- Check if the knob can be turned freely, if not, repeat the procedure.

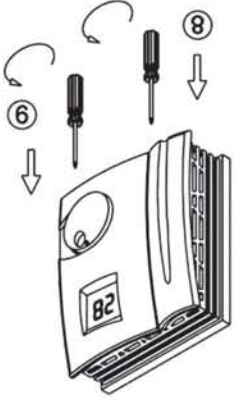
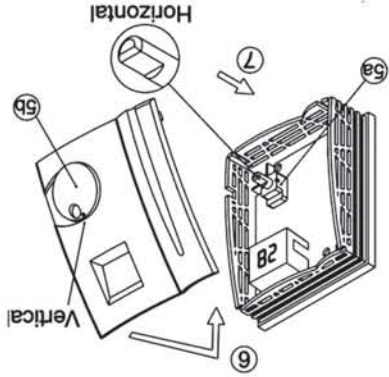

6. Temperature setting

- Select the desired temperature by turning the knob into a position that corresponds to the desired temperature and read the value on LCD display with hand icon.
- After 10-20 sec. the hand icon disappears and the display will show the current room temperature.

IMPORTANT INFORMATION ON PROPER DISPOSAL OF E-WASTE AS REQUIRED BY THE EC DIRECTIVE 2002/96/EC (WEEE)

Do not dispose of this product as unsorted municipal waste. Please dispose of this product by returning it to the point of sale or to your local municipal collection point for recycling. Respecting these rules will help to preserve, protect and improve the quality of the environment, protect human health and utilise natural resources prudently and rationally. The crossed out wheeled bin with marking bar, printed either in the Manual or on the product itself, identifies that the product must be disposed of at a recycling collection site.

